

Dimensions

Unit: mm (ft.in)

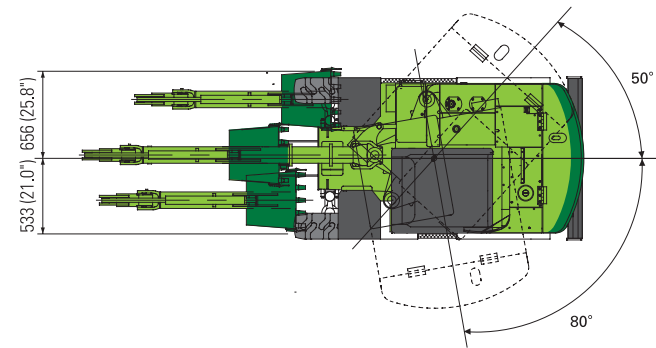

Working ranges

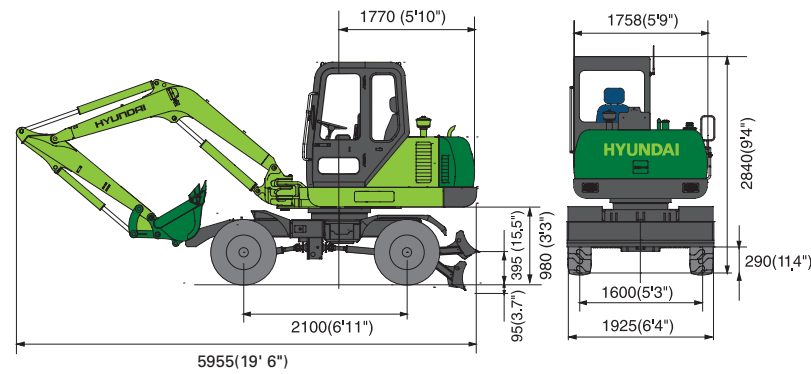
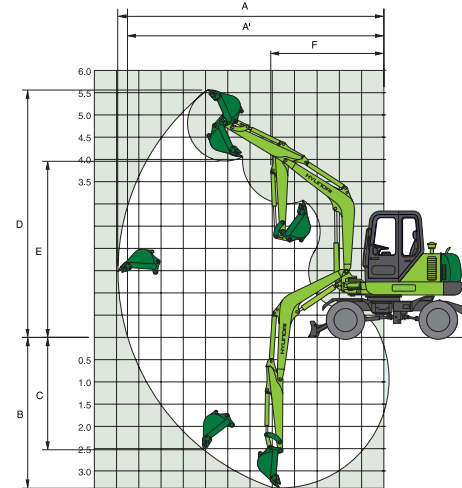

Boom length	2,840mm (9' 4")
Arm length	1,600mm (5' 3") 1,900mm (6' 3")
A Max. digging reach	5,985mm (19' 8") 6,250mm (20' 6")
A' Max. digging reach on ground	5,755mm (11' 11") 6,040mm (20' 0")
B Max. digging depth	3,420mm (11' 3") 3,680mm (12' 1")
C Max. vertical wall digging depth	2,525mm (8' 3") 2,730mm (9' 0")
D Max. digging height	5,555mm (18' 3") 5,650mm (18' 6")
E Max. dumping height	3,960mm (12' 12") 4,070mm (13' 4")
F Min. swing front radius	2,540mm (8' 4")
80° boom swing front radius	2,060mm (6' 9")

Standard Equipment

ISO standard cab

- All-weather steel cab with all-around visibility
- Safety glass windows
- Wide windshield wiper
- Sliding fold-in front window
- Sliding side window
- Lockable door
- Auto warm-up system
- Auto overheat prevention system

Fully adjustable suspension seat with seat belt
Removable clean out screen for radiator
AM/FM radio and cassette
Starting aid (air grid heater), cold weather

Centralized monitoring

- LCD type tachometer
- Engine coolant temperature gauge
- Engine oil pressure light
- Air-cleaner clogging light
- Charging light
- Engine overheat light
- Fuel meter and light
- Mechanical type hourmeter
- Illumination lights

Four front working lights

Battery (12V x 100AH)
Electric horn
Heater (2,700 kcal/hr 10,700 BTU/hr)
Door and cap locks, one key
Two outside rearview mirrors
Automatic swing brake
Removable reservoir tank
Water separator, fuel line
Counterweight (211 kg/465 lb)
One piece boom (2.84 m/9' 4")
Arm (1.6 m/5' 3")
Blade (1925 x 354 mm/6'4" x 14")
Standard bucket (0.18 m³, 0.24 yd³)
Tires (12.0 x 16.5-12PR)

Optional Equipment

Air-conditioner (2,850 kcal/hr 11,300 BTU/hr)
Heater, defroster
Sunvisor for cab inside
Fuel filler pump (35 lpm / min, 9.2US gpm)
Rotating beacon

Safety lock valve for boom cylinder
Breaker piping kit(Single & double acting)
Auxiliary accumulator
Fender

Various optional buckets (SAE heaped)
Narrow bucket (0.06 m³, 0.08yd³)
Long arm (1.9m / 6'3")
Quick coupler
Tool kit
Operator Suit

Standard and optional equipment may vary. Consult your Hyundai dealer for more information.
The machine shown may vary according to territorial specification.

HYUNDAI
HEAVY INDUSTRIES CO.,LTD.
CONSTRUCTION EQUIPMENT DIVISION

HEAD OFFICE 1 CHEONHA - DONG, DONG-KU, ULSAN, KOREA
(Sales Office) TEL : (82)(52)230 - 2114 FAX (82)(52)230-7979
HCE U.S.A 955 ESTES AVENUE ELK GROVE VILAGE ILL. 60007
TEL : (1)847 - 437 - 3333 FAX : (1)847 - 437 - 3574
HHI EUROPE N.V VOSSENDAAL 11, 2440 GEEL, BELGIUM
TEL : (32)14 - 562200 FAX : (32)14 - 593405 - 06

PLEASE CONTACT

www.hyundai-ce.com

2003. 4 rev4



Delux
55W-3
WHEEL EXCAVATOR

MINI EXCAVATOR

Yanmar 4TNE-94 Engine	43.5kW/58.3HP
Operating weight	5,140 kg (11,330 lb)
Bucket capacity, SAE	0.06 ~ 0.18m ³ (0.08 ~ 0.24 yd ³)
Standard equipment	
Reach on ground level	5,755mm (18'11")
Digging depth	3,420mm (11' 3")
Travel speed	8.0~27.0km/h (5.0~16.9 mph)

HYUNDAI
HEAVY INDUSTRIES CO.,LTD.

Photo may include optional equipment.

THE HYUNDAI ROBEX 55W-3 HYDRAULIC EXCAVATOR

A small machine for big jobs. The Hyundai R55W-3 mini excavator is a dense pack of power, perfect for getting in the tight places where the big machines can't go. Operating an R55W-3 is done with simple and perfect control. You'll experience the most comfort and best visibility possible in this class of machine. The R55W-3's absolute reliability will keep you running as long as you need to be.

"The R55W-3 from Hyundai. It's here to work. It's here to stay."





Spacious and comfortable cabin

The high quality, fully adjustable seat provides you with a more comfortable operating environment. This allows you to work longer with less fatigue.

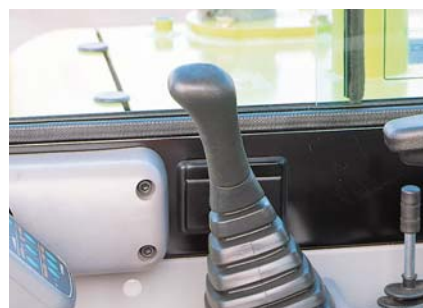

Semi-long joysticks lever

Long lever grip applied to joysticks gives an operator smooth and comfortable feel. The longer grip of the joystick lever is provided for precise control

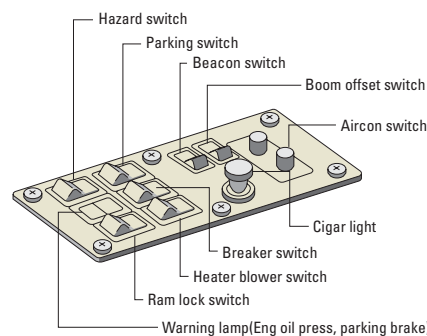

Centralized switch board

Various function switches are centralized for the operator's comfort



Reliable monitor with tilt angle adjustable cluster

You'll find this handy control cluster at your fingertips. From here, you can check E/G speed and fuel level, and activate your E/G pre-heater, heater, two-speed travel indicator, and working lights.

Pre-heating system

When you place the starting switch to the "on" position and press the pre-heat button, four LED lamps get turned on one after another within 15 sec and flicker together two times. Even if these LED lamps stay on, this pre-heating ceases to function once your excavator has already got started.

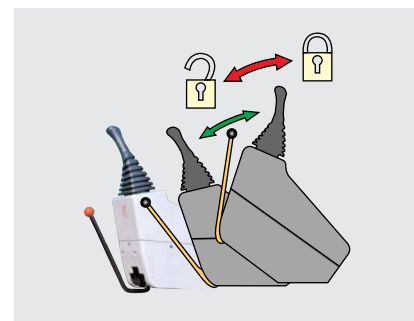

Safety locking system

The left hand joystick console lifts up and into a locked position to widen your entrance into the cab. The joystick controls will remain safely inoperable until the console is lowered and snapped back into place.



Large sunroof

A large sunroof fitted in the cabin overhead provides you with best visibility when the machine is working



Your home away from home

Your job sometimes puts you in your excavator for long period of time. You need a machine you can feel good in. This is accomplished with a low vibration engine, cabin-mounted rubber insulation, and a specially treated sound absorption compound.



Offset boom swing

The R55W-3 is designed for efficient work in congested residential and urban areas. The boom can be offset within a range of 130 degrees.



Rugged work equipment

Casting is used for high stress area such as boom-foot, boom-lug and boom swing unit
Stress ribs are installed at arm



Visible pre-cleaner

The pre-cleaner works hard to extend the service life of your main air cleaner by removing larger impurities from the air intake system.

Easy access

Full open doors and single key system provide easy service
 You'll find that the R55W-3 offers plenty of space to complete your regular maintenance service hassle-free.



· Photo may include optional equipment.

Engine

Model Yanmar 4TNE-94
 Type Water cooled, 4 cycle Diesel 4-cylinders in line, direct injection, low emission
 Rated flywheel horsepower
 SAE J1995 (gross) 58.3 HP (43.5 kW) at 2500 rpm
 J1349 (net) 57.7 HP (43 kW) at 2500 rpm
 DIN 6271/1(gross) 59.1 PS (43.5 kW) at 2500 rpm
 6271/1(net) 58.5 PS (43 kW) at 2500 rpm
 Max. torque 19.4 kgf·m (140 lbf·ft) at 1600 rpm
 Bore 94 mm (3.70")
 Stroke 100 mm (3.94")
 Piston displacement 2776 cc (169.5 cu.in)
 Batteries 12 V x 100 AH
 Starting motor 12 V - 2.3kW
 Alternator 12 V - 40 Amp

Hydraulic system

Main pump
 Type Variable displacement piston pump
 Rated flow 2 x 52.25 lpm (13.8 US gpm/11.5 UK gpm)
 Auxiliary hydraulic flow 40.5 lpm (10.7 US gpm/8.9 UK gpm)
 Sub-pump for pilot circuit Gear pump
 Hydraulic motors
 Travel Two speed axial piston motor with brake valve and parking brake
 Swing Axial piston motor with automatic brake
 Relief valve setting
 Implement circuits 210 kgf/cm² (2985 psi)
 Travel 210 kgf/cm² (2985 psi)
 Swing circuit & dozer blade 170 kgf/cm² (2415 psi)
 Pilot circuit 30 kgf/cm² (425 psi)
 Service valve Installed
 Hydraulic cylinders
 No. of cylinder-bore x rod x stroke
 Boom : 1 - 100 x 55 x 620 mm (3.9" x 2.2" x 24.4")
 Arm : 1 - 85 x 50 x 760 mm (3.3" x 2.0" x 30.0")
 Bucket : 1 - 80 x 50 x 580 mm (3.2" x 2.0" x 23.0")
 Boom swing : 1 - 95 x 50 x 631 mm (3.7" x 2.0" x 24.8")
 Dozer blade : 1 - 100 x 50 x 159 mm (3.9" x 2.0" x 6.3")

Controls

Pilot pressure-operated joysticks and pedals with detachable levers provide easy and fatigueless operation.
 Pilot control Two joysticks with one safety lever (LH) : Swing and arm, (RH) : Boom and bucket (ISO pattern)
 Engine throttle Lever type
 External lights Two lights mounted on the boom one below the cab, one below the battery box

Swing system

Swing motor Axial piston motor
 Swing reduction Planetary gear reduction
 Swing gear lubrication Grease
 Swing brake Wet, multi-disc
 Swing speed 10.0 rpm

Steering system

Hydraulically actuated, orbitrol type steering system actuates on front wheels through the steering cylinders.
 Min. turning radius 5005mm (16'5")

Undercarriage

Reinforced box-section frame is of high-tensile strength steel.
 Pin-on type dozer blade is standard.
 Dozer blade a very useful addition for leveling and back filling or clean-up work.

Drives & Brakes

4-wheel hydrostatic drive, constant mesh, helical gear transmission provides 2 forward and reverse travel speeds.
 Max. drawbar pull 2800 kgf (6170 lbf)
 1st (forward/ reverse) 8.0 km/hr (5.0 mph)
 Travel Speed 2st (forward/ reverse) 27 km/hr (16.8 mph)
 Gradeability 30° (58%)
 Service brake independent brake system, front and rear axle full hydraulic power brake. spring released and hydraulic applied wet type multiple disc brake.

Axles & wheel

Full floating front axle is supported by center trunion for oscillation. It can be locked by oscillation lock cylinders.
 Rear axle is fixed on the lower chassis.
 Tires 12.0 x 16.5-12PR.single

Coolant & Lubricant capacity

	liter	US gal	UK gal
Fuel tank	125.0	33.0	27.5
Engine coolant	10.4	2.7	2.3
Engine oil	9.7	2.6	2.1
Swing device	0.5	0.16	0.1
Final drive(each)	4.4	1.2	1.0
Axle(front)	5.3	1.4	1.2
(rear)	5.3	1.4	1.2
Hydraulic tank	80.0	21.0	17.6

Operating weight (approximate)

Operating weight, including 2,840 mm (9'4") one-piece boom, 1,600 mm (5'3") arm, SAE heaped 0.18 m³ (0.24 yd³) excavator bucket, lubricant, coolant, fuel tank, hydraulic tank and the standard equipment.
 Operating weight 5,140kg (11,330lb)
 Major component weight
 Upper structure 2,475 kg (5,460 lb)
 Counter weight 211 kg (465 lb)
 Boom (with arm cylinder) 258 kg (570 lb)

Dozer blade

Width x height 1925 x 354 mm (6' 4" x 14")
 Max. lifting above ground level 395 mm (15.5")
 Max. depth below ground level 95 mm (3.7")

Buckets

Capacity		Width		Weight	2.9m (9'6") Boom	
SAE heaped	CECE heaped	Without side cutters	With side cutters		1.6m (5'3") arm	1.9m (6'3") arm
0.06 m ³ (0.08 yd ³)	0.05 m ³ (0.07 yd ³)	315 mm (12.4")	360 mm (14.2")	84 kg (151 lb)	●	●
*0.18 m (0.24 yd ³)	0.15 m ³ (0.20 yd ³)	705 mm (27.8")	770 mm (30.3")	137 kg (300 lb)	■	▲

* : Standard backhoe bucket
 ● Applicable for materials with density 2000 kg/m³ (3370 lb/yd³) or less
 ▲ Applicable for materials with density 1100 kg/m³ (1850 lb/yd³) or less
 ■ Applicable for materials with density 1600 kg/m³ (2700 lb/yd³) or less

Arm	Length	*1.60m (5'3")	1.90m (6'3")
		Weight	Weight
Bucket digging force	SAE	32.1 kN 3270 kgf 7210 lbf	32.1 kN 3270 kgf 7210 lbf
	ISO	36.4 kN 3710 kgf 8180 lbf	36.4 kN 3710 kgf 8180 lbf
Arm crowd force	SAE	22.0 kN 2240 kgf 4940 lbf	18.9 kN 1930 kgf 4260 lbf
	ISO	22.7 kN 2310 kgf 5090 lbf	20.0 kN 2000 kgf 4410 lbf

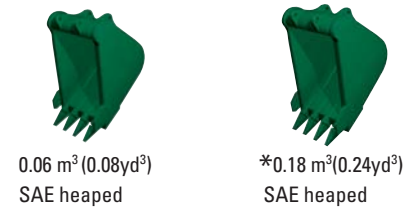

* : Standard Arm

Lifting capacities

: 2,840mm (9' 4") : 1,600mm (5' 3") : 0.18m³ (0.24yd³) SAE heaped
 Rating over-front Rating over-side or 360 degree

Dozer blade down with 211kg (465 lb) counterweight

Load point height m(ft)	Load radius								At max. reach			
	2.0m (5.0ft)		3.0m (10.0ft)		4.0m (15.0ft)		5.0m (15.0ft)		Capacity	Reach		
5.0m 15.0ft	kg lb								*690 *690	*690 *690	4.31 (14.1)	
4.0m 15.0ft	kg lb				*750 *1650	*750 *1650			*700 *1540	*700 *1540	5.15 (16.9)	
3.0m 10.0ft	kg lb				*810 *1790	*810 *1790			*720 *1590	*720 *1590	5.60 (18.4)	
2.0m 5.0ft	kg lb	*2770 *6110	*2770 *6110	*1330 *2930	*1330 *2930	*980 *2160	*980 *2160	*840 *1850	*840 *1850	*740 *1630	730 1610	5.77 (18.9)
1.0m 5.0ft	kg lb			*1760 *3880	*1760 *3880	*1160 *2560	*1160 *2560	*900 *1980	880 1940	*760 *1680	740 1630	5.71 (18.7)
Ground Line	kg lb	*2410 *5310	*2410 *5310	*1900 *4190	*1830 *4030	*1240 *2730	1200 2650			*780 *1720	*780 *1720	5.40 (17.7)
-1.0m -5.0ft	kg lb	*3020 *6660	*3020 *6660	*1760 *3880	*1760 *3880	*1150 *2540	*1150 *2540			*780 *1720	*780 *1720	4.77 (15.6)
-2.0m -5.0ft	kg lb	*2110 *4650	*2110 *4650	*1270 *2800	*1270 *2800							

: 2,840mm (9' 4") : 1,900mm (6' 3") : 0.18m³ (0.24yd³) SAE heaped
 Rating over-front Rating over-side or 360 degree

Dozer blade down with 211kg (465 lb) counterweight

Load point height m(ft)	Load radius								At max. reach			
	2.0m (5.0ft)		3.0m (10.0ft)		4.0m (15.0ft)		5.0m (15.0ft)		Capacity	Reach		
5.0m 15.0ft	kg lb								*590 *1300	*590 *1300	4.72 (15.5)	
4.0m 15.0ft	kg lb								*530 *1170	*530 *1170	5.47 (17.9)	
3.0m 10.0ft	kg lb						*690 *1520	*690 *1520	*520 *1150	*520 *1150	5.88 (19.3)	
2.0m 5.0ft	kg lb			*1120 *2470	*1120 *2470	*880 *1940	*880 *1940	*770 *1700	*770 *1700	*540 *1190	*540 *1190	6.05 (19.8)
1.0m 5.0ft	kg lb	*2020 *4450	*2020 *4450	*1620 *3570	*1620 *3570	*1080 *2380	*1080 *2380	*850 *1870	*850 *1870	*590 *1300	*590 *1300	5.99 (19.7)
Ground Line	kg lb	*2300 *5070	*2300 *5070	*1870 *4120	1820 4010	*1210 *2670	1190 2620	*890 1900	860	*680 *1500	*680 *1500	5.70 (18.7)
-1.0m -5.0ft	kg lb	*3020 *6660	*3020 *6660	*1830 *4030	1810 3990	*1200 *2650	1180 2600			*740 *1630	*740 *1630	5.13 (16.8)
-2.0m -5.0ft	kg lb	*2560 *5640	*2560 *5640	*1490 *3280	*1490 *3280							

Notes : 1. Lifting capacity is based on SAE J1097, ISO 10567
 2. Lifting capacity of the Robex Series does not exceed 75% of tipping load with the machine on firm, level ground or 87% of full hydraulic capacity.
 3. The load point is a hook located on the back of the bucket. 4 "*" indicates the load limited by hydraulic capacity.